



*QUICK REFERENCE GUIDE*

## *HM78X DIGITAL MOBILE RADIO*



is the trademark or registered trademark of Hytera Communications Corporation Limited.  
© 2020 Hytera Communications Corporation Limited. All Rights Reserved.

Address: Hytera Tower, Hi-Tech Industrial Park North, 9108#BeiHuan Road,  
Nanshan District, Shenzhen, People's Republic of China

Postcode: 518057  
<http://www.hytera.com>

190335437 06073207



5202010062847A



## Tools

- Electric drill
- Phillips screwdriver
- T20 torx screwdriver

## Parts

No.	Part Name	No.	Part Name
1	Radio	6	Screw (4 mm x 16 mm)
2	Locking Knobs	7	Microphone Hanger
3	Mounting Bracket	8	GPS Antenna
4	Screw (4.8 mm x 20 mm)	9	Power Cord (with fuse)
5	Palm Microphone	10	RF Antenna

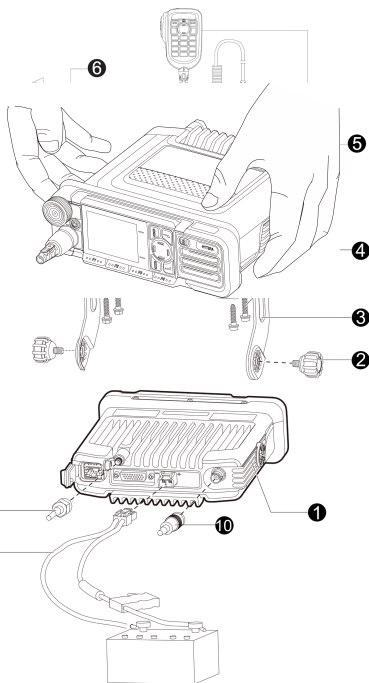

### NOTE

- The RF antenna must be purchased separately.
- The GPS antenna is available only for radios with the GPS feature.
- The palm microphone without keypad (with ⑥ and ⑦) is available for the conventional radio, and the one with keypad (with ⑥ and ⑦) is for the trunking radio.

3. Insert the TF card to the metal card slot properly as directed in the following figure.

## Procedure

### Installing the TF Card

1. Release the latch on both sides of the plastic upper cover.

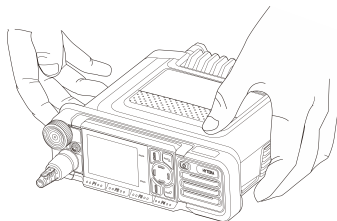

4. Align the concave side of the plastic upper cover with the aluminum chassis, and then press the cover until the latches are properly locked.

2. Hold the front panel, and then pull and remove the plastic upper cover.

## Installing the Radio

1. Select a location, drill holes based on the shape of the mounting bracket, and then use the screws (4.8 mm x 20 mm) to secure the bracket.
2. Connect the RF antenna, GPS antenna, and power cord to the radio.
3. Slide the radio into the mounted bracket, and then secure it by using the locking knobs.
4. Install the microphone hanger in a location where you can reach it easily, and then use the screws (4 mm x 16 mm) to secure it.
5. Align the triangle index on the palm microphone with the installation index, plug the connector into the radio, and then rotate the connector clockwise to secure it.
6. Place the palm microphone on the hanger.

## Basic Operations

### Turning On or Off the Radio

- To turn on the radio, long press the **On-Off** key.
- To turn off the radio, press the **On-Off** key.

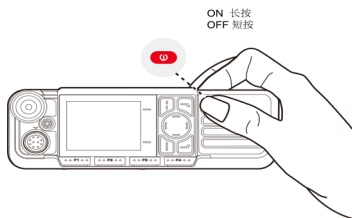

### Adjusting the Volume

To increase or decrease the volume, rotate the **Smart** knob clockwise or counter-clockwise.

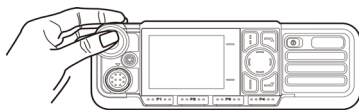

## Switching the Operation Mode

The radio can operate in conventional mode, or digital/analog trunking mode (enabled by your dealer).

To switch the operation mode, do either of the following:

- Go to **Menu > Mode**, press the **Navigation** key up or down to select the mode, and then press the **OK/Menu** key.
- Press the preprogrammed **Operation Mode Switch** key.

### Conventional Mode

#### Selecting a Zone

Go to **Menu > Zone**, press the **Navigation** key up or down to select the zone, and then press the **OK/Menu** key.

#### Selecting a Channel

##### Through Smart Knob

On the home screen, press the **Smart** knob, and then rotate the knob within 5s.

##### Through Menu

1. Go to **Menu > Zone**.
2. Press the **Navigation** key up or down to select the zone.
3. Press the **Navigation** key up or down to select the channel.
4. Press the **OK/Menu** key.

### Trunking Mode

#### Selecting a Group or Private Contact

##### Through Smart Knob

On the home screen, press the **Smart** knob, and then rotate the knob within 5s.

##### Through Menu

1. On the home screen, press the **Back/Subgroup** key, or go to **Menu > Subgroup**.
2. Press the **Navigation** key up or down to select the subgroup.
3. Press the **Navigation** key up or down to select the group or private contact.
4. Press the **OK/Menu** key.







### Selecting a Subgroup

1. On the home screen, press the **Back/Subgroup** key, or go to **Menu > Subgroup**.
2. Press the **Navigation** key up or down to select the subgroup.
3. Press the **OK/Menu** key.

## Status Indications

### LCD Icons

Icon	Radio Status
	The radio detects no signal.
	The number of bars indicates the signal strength.
	The radio operates in low power mode.
	The radio operates in high power mode.
	An accessory is connected.
	The Mode Automatic Switch feature is enabled.
	The radio is scanning.
	The Voice Operated Transmit (VOX) feature is enabled.
	The radio operates in silent mode.

	The radio operates in profile 1.
	The radio operates in profile 2.
	The radio is in emergency mode.
	There is/are missed call(s).
	There is/are unread message(s).
	The inbox is full.

For more status icons, refer to the User Manual.

## LED Indicators

LED Indicator	Radio Status
Flashes green	The radio is being turned on.
Flashes green slowly	The radio is standby in trunking mode.
Glow green	The radio is receiving.
Glow red	The radio is transmitting.
Flashes red	The radio is establishing a call in trunking mode. This indication is applicable only to the calling radio.
Flashes orange slowly	<ul style="list-style-type: none"> <li>Conventional mode: The radio is scanning or roaming.</li> <li>Trunking mode: The radio is scanning.</li> </ul>
Flashes orange rapidly	<ul style="list-style-type: none"> <li>Conventional mode: The radio is operating in emergency mode.</li> <li>Trunking mode: The radio is establishing a Full Off Air Call Set-up (FOACSU) private call. This indication is applicable only to the called radio.</li> </ul>
Glow orange	Call hang time: No voice is being transmitted or received during a call. Within such a period, you can press and hold the <b>PTT</b> key and speak.

Flashes blue every 3s	The BT feature is enabled, but no BT device is connected.
Flashes blue every 1.5s	A BT device is connected.
Flashes blue every 0.1s	The BT feature is being disabled.

## Call Services

### Call on Digital Channel

#### Through Smart Knob

- On the home screen, press the **Smart** knob.
- Rotate the **Smart** knob within 5s to select the digital channel or contact.
- Press and hold the **PTT** key.

#### Through Menu

- Go to **Menu > Contact** or **Zone/Subgroup**.
- Press the **Navigation** key up or down to select the contact.
- Press and hold the **PTT** key.

### Call on Analog Channel

#### Call Without Signaling

- On the home screen, press the **Smart** knob.
- Rotate the **Smart** knob within 5s to select the analog channel.
- Press and hold the **PTT** key.

#### Call with Signaling

- Go to **Menu > Contact > Contact/Favorite**, or press the preprogrammed **Contact List** key.

- Press the **Navigation** key up or down to select the contact.
- Press and hold the **PTT** key, or press the preprogrammed **One Touch Call/Menu** key.

## Emergency Call

The Emergency feature is configured and enabled by your dealer. For details, refer to the User Manual.

For details on more features and operations, please visit our website at <http://www.hytera.com> or scan the QR code to download the User Manual.

